

Soils Map

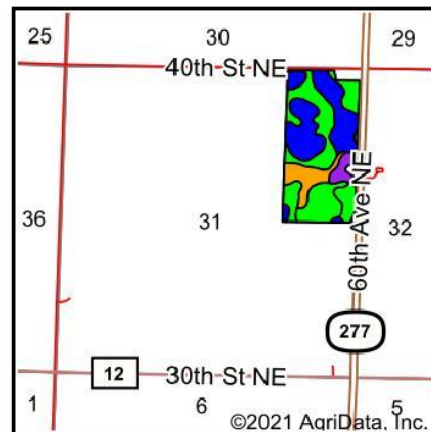

State: **Minnesota**
 County: **Chippewa**
 Location: **29-119N-38W**
 Township: **Louriston**
 Acres: **71.98**
 Date: **6/17/2021**

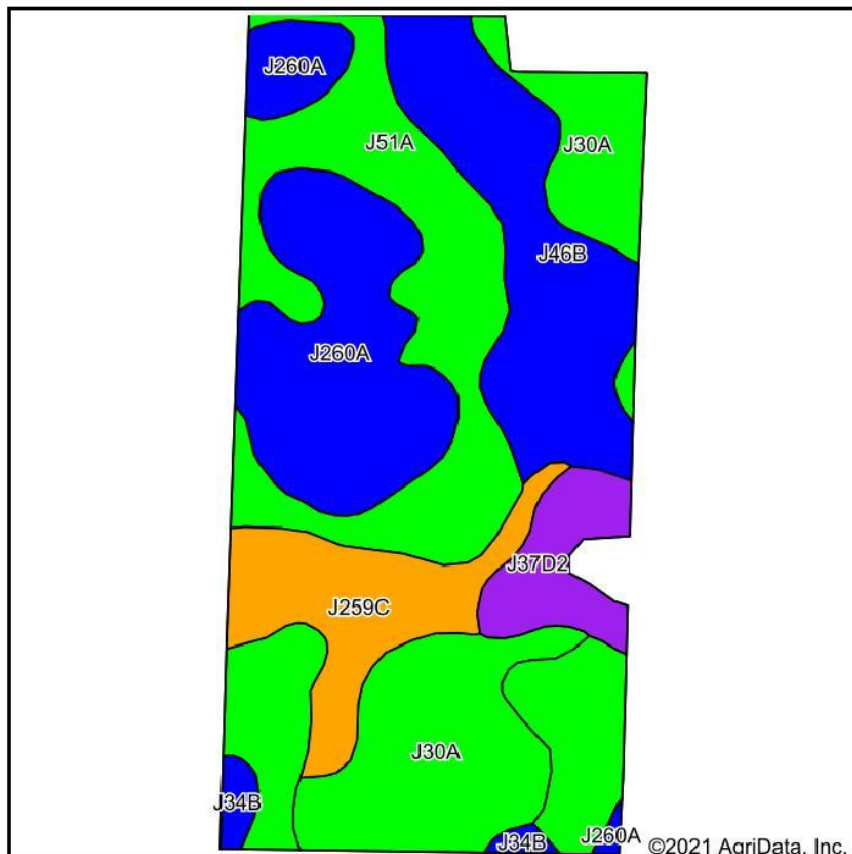
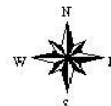

Soils data provided by USDA and NRCS.

Area Symbol: MN023, Soil Area Version: 23

Code	Soil Description	Acres	Percent of field	PI Legend	Non-Irr Class *c	Productivity Index	Brome grass alfalfa hay	Corn	Oats	Soybeans	Spring wheat	*n NCCPI Soybeans
J51A	Bearden-Quam, depressional, complex, 0 to 2 percent slopes	21.64	30.1%		Ils	91	4	159	79	50	56	74
J260A	Colvin-Quam complex, depressional, 0 to 1 percent slopes	13.54	18.8%		IIIw	86	3.5	150	73	47	51	74
J30A	Tara silt loam, 1 to 3 percent slopes	13.24	18.4%		Ie	99						79
J46B	Byrne silt loam, 1 to 6 percent slopes	11.73	16.3%		Ile	90						76
J259C	Buse-Doland complex, 6 to 12 percent slopes	7.30	10.1%		IIIe	75	3.6	131	66	41	46	52
J37D2	Langhei-Barnes, moderately eroded, complex, 12 to 20 percent slopes	3.60	5.0%		IVe	60						53
J34B	Byrne-Buse complex, 2 to 6 percent slopes	0.93	1.3%		Ile	90	4.7	156	82	49	57	68
Weighted Average						88.2	2.3	91.3	45.2	28.7	31.8	*n 71.9

*n: The aggregation method is "Weighted Average using all components"

*c: Using Capabilities Class Dominant Condition Aggregation Method

Soils data provided by USDA and NRCS.