



## CRS Data

### LOCATION

**Property Address** No Address Available  
SC

**Subdivision** Sunvalley Court

**County** Marion County, SC

### PROPERTY SUMMARY

**Property Type** Residential

**Land Use** Residential

**Improvement Type** Residential

**Square Feet**

### GENERAL PARCEL INFORMATION

**Parcel ID/Tax ID** 055-00-00-169-000

**Alternate Parcel ID**

**Account Number**

**District/Ward**

**2010 Census Trct/Blk** 9502/3

**Assessor Roll Year** 2015

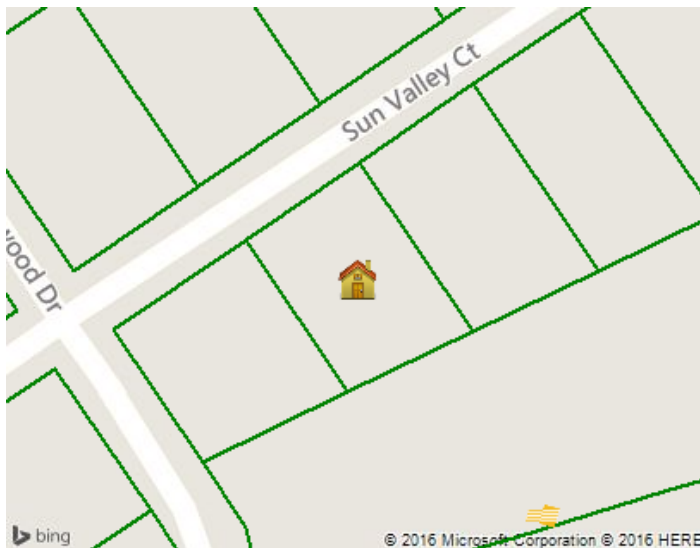

### CURRENT OWNER

**Name** Jenkins Ray

**Mailing Address** 1902 Sun Valley Ct  
Marion, SC 29571-6625

### SALES HISTORY THROUGH 04/26/2016

No sales information was found for this parcel.

### TAX ASSESSMENT

Appraisal	Amount	Assessment	Amount
Appraisal Year	2015	Assessment Year	2015
Appraised Land	\$14,000	Assessed Land	
Appraised Improvements		Assessed Improvements	
Total Tax Appraisal	\$14,000	Total Assessment	\$560
		Exempt Amount	
		Exempt Reason	

### TAXES

Tax Year	City Taxes	County Taxes	Total Taxes
2015			
2014			
2013			

### MORTGAGE HISTORY

No mortgages were found for this parcel.

### PROPERTY CHARACTERISTICS: BUILDING

No Buildings were found for this parcel.

### PROPERTY CHARACTERISTICS: EXTRA FEATURES

No extra features were found for this parcel.

## PROPERTY CHARACTERISTICS: LOT

<b>Land Use</b>	Residential	<b>Lot Dimensions</b>
<b>Block/Lot</b>	/25	<b>Lot Square Feet</b>
<b>Latitude/Longitude</b>	34.191649°/-79.349895°	<b>Acreage</b>

## PROPERTY CHARACTERISTICS: UTILITIES/AREA

<b>Gas Source</b>	<b>Road Type</b>
<b>Electric Source</b>	<b>Topography</b>
<b>Water Source</b>	<b>District Trend</b>
<b>Sewer Source</b>	<b>Special School District 1</b>
<b>Zoning Code</b>	<b>Special School District 2</b>
<b>Owner Type</b>	

## LEGAL DESCRIPTION

<b>Subdivision</b>	Sunvalley Court	<b>Plat Book/Page</b>
<b>Block/Lot</b>	/25	<b>District/Ward</b>
<b>Description</b>	Lot 25 Sunvalley Court(Pa	

## FLOOD ZONE INFORMATION

<b>Zone Code</b>	<b>Flood Risk</b>	<b>BFE</b>	<b>Description</b>	<b>FIRM Panel ID</b>	<b>FIRM Panel Eff. Date</b>
X	Minimal		Area of minimal flood hazard, usually depicted on FIRMs as above the 500-year flood level.	45067C0153E	10/18/2011