



## LOCATION

**Property Address** 211 Pine St  
Seneca, SC 29678-3303

## Subdivision

**County** Oconee County, SC

## PROPERTY SUMMARY

**Property Type** Residential

**Land Use** Residential 1 Family

## Improvement Type

## Square Feet

## GENERAL PARCEL INFORMATION

**Parcel ID/Tax ID** 520-33-08-017

## Alternate Parcel ID

**Account Number** 57221

**District/Ward** 200

**2010 Census Trct/Blk** 308/4

**Assessor Roll Year** 2015

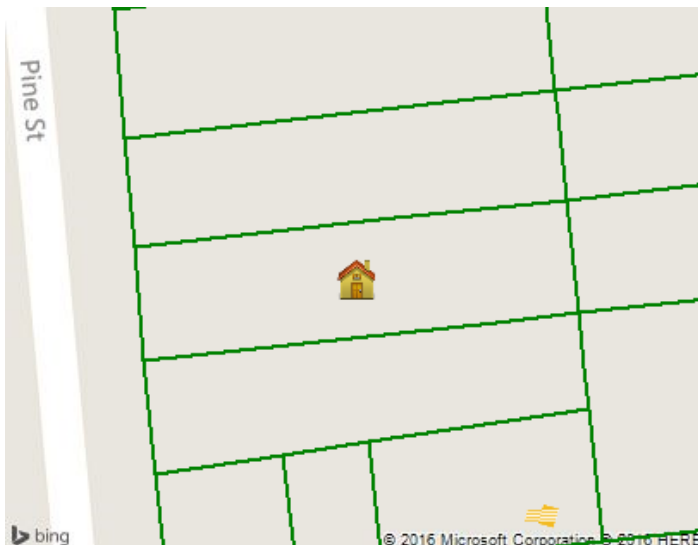

## CURRENT OWNER

**Name** Dudley Kenneth Barrett

**Mailing Address** 138 Angel Dr  
Winston Salem, NC 27101

## SALES HISTORY THROUGH 06/03/2016

Date	Amount	Buyer/Owners	Buyer/Owners 2	Instrument	No. Parcels	Book/Page or Document#
1/5/2016	\$1,300	Dudley Kenneth Barrett		Tax Sale Deed		2156/166 004686290003
2/8/1982		Dendy William Etal				

## TAX ASSESSMENT

Appraisal	Amount	Assessment	Amount
Appraisal Year	2015	Assessment Year	2015
Appraised Land	\$10,220	Assessed Land	\$408
Appraised Improvements		Assessed Improvements	
Total Tax Appraisal	\$10,220	Total Assessment	\$408
Assessment Rate	4.00%	Exempt Amount	
		Exempt Reason	

## TAXES

Tax Year	City Taxes	County Taxes	Total Taxes
2015			\$508.06
2014			\$508.06
2013			\$508.06

## MORTGAGE HISTORY

No mortgages were found for this parcel.

## PROPERTY CHARACTERISTICS: BUILDING

No Buildings were found for this parcel.

#### PROPERTY CHARACTERISTICS: EXTRA FEATURES

No extra features were found for this parcel.

#### PROPERTY CHARACTERISTICS: LOT

<b>Land Use</b>	Residential 1 Family	<b>Lot Dimensions</b>	
<b>Block/Lot</b>		<b>Lot Square Feet</b>	10,890
<b>Latitude/Longitude</b>	34.680967°/-82.957118°	<b>Acreage</b>	0.25
<b>Type</b>	<b>Land Use</b>	<b>Size</b>	<b>Tax Assessor Value</b>
		0.23 Ac	
		0.02 Ac	

#### PROPERTY CHARACTERISTICS: UTILITIES/AREA

<b>Gas Source</b>	<b>Road Type</b>
<b>Electric Source</b>	<b>Topography</b>
<b>Water Source</b>	<b>District Trend</b>
<b>Sewer Source</b>	<b>Special School District 1</b>
<b>Zoning Code</b>	<b>Special School District 2</b>
<b>Owner Type</b>	

#### LEGAL DESCRIPTION

<b>Subdivision</b>	<b>Plat Book/Page</b>
<b>Block/Lot</b>	<b>District/Ward</b> 200
<b>Description</b>	

#### FLOOD ZONE INFORMATION

<b>Zone Code</b>	<b>Flood Risk</b>	<b>BFE</b>	<b>Description</b>	<b>FIRM Panel ID</b>	<b>FIRM Panel Eff. Date</b>
X	Minimal		Area of minimal flood hazard, usually depicted on FIRMs as above the 500-year flood level.	45073C0337C	09/11/2009