

Douglas County, Nebraska Property Record - R2416500773

Information is valid as of 2016-09-16

[Print Report](#)  
[Treasurer's Tax Report](#)  
**New Feature** → → → [Subdivision Sales Search](#)

Owner

OMAHA HOUSING AUTHORITY

1805 HARNEY ST  
OMAHA NE 68102-0000

Property Information

<b>Key Number:</b>	1650 0773 24
<b>Account Type:</b>	Ex Government
<b>Parcel Number:</b>	2416500773
<b>Parcel Address:</b>	10914 JONES ST OMAHA NE 68154-0000
<b>Legal Description:</b>	WEAR'S WEST PACIFIC ADD LOT 12 BLOCK 9 IRREG

Value Information

	<i>Land</i>	<i>Improvement</i>	<i>Total</i>
2016	\$0.00	\$0.00	\$0.00
2015	\$0.00	\$0.00	\$0.00
2014	\$0.00	\$0.00	\$0.00
2013	\$0.00	\$0.00	\$0.00
2012	\$0.00	\$0.00	\$0.00
2011	\$0.00	\$0.00	\$0.00

Land Information

<i>Acres</i>	<i>SF</i>	<i>Units</i>	<i>Depth</i>	<i>Width</i>	<i>Vacant</i>
0.16	7276.0	0.0	107.0	68.0	Yes

Land Attributes

<i>Attribute</i>	<i>Attribute Description</i>
Negative Influence	Location 55

Improvement Information

Building 1

--	--



MARCH 2015 DOUGLAS COUNTY ASSESSOR

[CLICK TO ENLARGE IMAGE](#)

10914 Jones St  
Ranch  
Bsmnt Block 8 ft  
912.0 sf

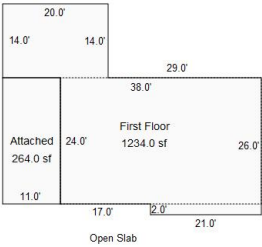

Sketch by Apex Medina™

[CLICK TO ENLARGE IMAGE](#)

<b>Square Footage:</b>	1234.0	<b>Percent Complete:</b>	100.0%
<b>Perimeter</b>	0.0	<b>Quality:</b>	Average
<b>Unit Type:</b>		<b>Condition:</b>	Average
<b>Built As:</b>	Ranch	<b>Condo Square Footage:</b>	0.0
<b>HVAC:</b>	Central Air to Air	<b>Rooms:</b>	6.0
<b>Exterior:</b>	Frame Vinyl	<b>Units:</b>	1.0
<b>Interior:</b>	Drywall	<b>Baths:</b>	1.0
<b>Roof Cover:</b>	Composition Shingle	<b>Bedrooms:</b>	3.0
<b>Roof Type:</b>	Gable	<b>Stories:</b>	1.0
<b>Floorcover:</b>	Allowance	<b>Foundation:</b>	Block
		<b>Sprinkler Square Footage:</b>	0.0

<i>Year Built</i>	<i>Year Remodeled</i>	<i>Percent Remodeled</i>	<i>Adjusted Year Built</i>	<i>Physical Age</i>
1970	1979	0%	1970	47

<i>Detail Type</i>	<i>Detail Description</i>	<i>Units</i>
Add On	Fence Chain Link	1.0
Appliance	Allowance	1.0
Basement	Bsmnt Block 8 ft	912.0
Fixture	Base Fixtures	1.0
Fixture	Bath Full	1.0
Garage	Attached	264.0
Porch	Open Slab	90.0

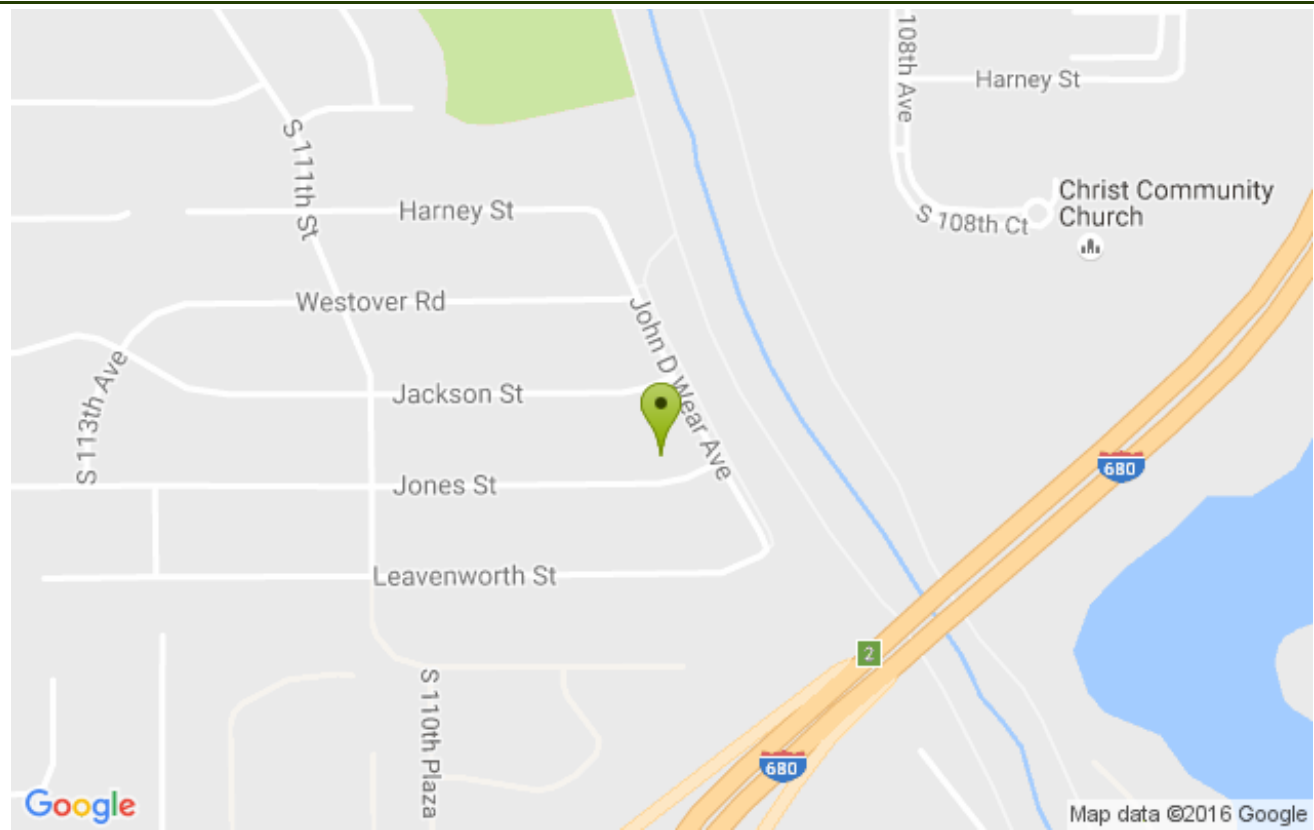

To interact more fully with Google Maps and Street View go to this link [Google](#).