

# Lake County, Ohio - Property Record Card

Parcel: 11B043E000410 Card: 1

Owner ROWAN ERIN C  
Address 960 LAKE TERRACE DR  
Land Use (510) R - SINGLE FAMILY DWELLING, PLATTED LOT  
Class RESIDENTIAL  
Legal Description LAKE TERRACE ESTATES NO 2 SPLIT 03-14 FR 11B-43-17 60FF

## SKETCH

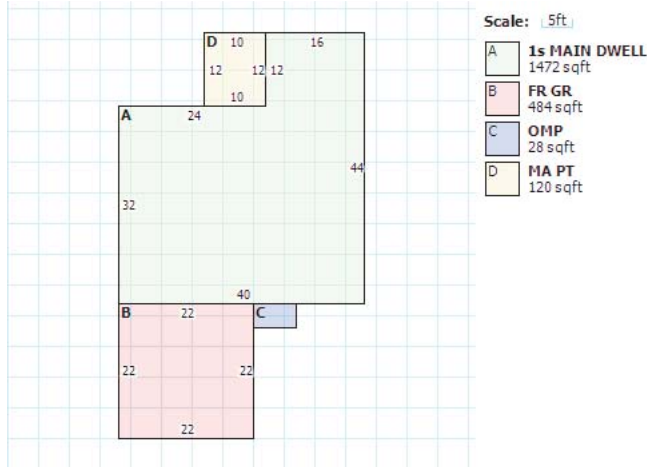

## RESIDENTIAL

Building Style	RANCH	FullBaths	2
Sq.Ft.	1472	Half Baths	0
Year Built	2005	Basement	NONE
Stories	1	Basement Area	0
Exterial Wall	ALUMINIUM/VINYL SIDING	Rec Room Area	0
Rooms	5	Heat Fuel Type	GAS
Bedrooms	3	Heat/Cool	+ AIR CONDITION
Family Rooms	0	Attic	NONE
Fireplace Openings(Stacks)	()	Trim	0

## LAND

Code	Frontage	Depth	Acreage	SqFt	Value
1	0	0	0.179	N/A	\$15,470.0

## VALUATION

	Appraised	Assessed
Land Value	\$15,470.00	\$5,410.00
Building Value	\$108,840.00	\$38,090.00
Total Value	\$124,310.00	\$43,500.00
CAUV Value	\$0.00	
Taxable Value	\$43,500.00	

## PERMITS

Number	Date	Purpose	Amount
20043542	09-NOV-04	DWELLING	

## IMPROVEMENTS

## SALES

Date	Buyer	Seller	Price	Validity
2/19/2008	ROWAN ERIN C	KAUFMAN THOMAS M	\$159,900.000	
7/24/2006	KAUFMAN THOMAS M	LAKE COUNTY COMMUNITY	\$149,000.000	

Note: Appraised valuations and taxes are reflective of the current tax year only. All land and building data changes made since the last tax duplicate will be reflected in the subsequent tax year's appraised valuations and corresponding tax bills.

Disclaimer: Information included in this site is believed to be accurate, but is not guaranteed. Lake County is not liable for errors or omissions.