

PARID: 480040002500
NBHD: 67800
ANDERSON DEBORAH JOAN

JUR: 04
ROLL: RP_OH
1910 RENKO RD

Parcel

Address 1910 RENKO RD
Unit
Class R - RESIDENTIAL
Land Use Code 511 - 511
Tax Roll RP_OH
Neighborhood 67800 - SAYBROOK TOWNSHIP
Acres .54
Taxing District 48
District Name SAYBROOK TWP-ASHTABULA A CSD
Gross Tax Rate 80.96
Effective Tax Rate 58.857946

Owner

Tax Year 2017
Owner ANDERSON DEBORAH JOAN
Address 1910 RENKO ROAD
ASHTABULA OH 44004
Notes

Tax Mailing Name and Address

Mailing Name 1 ANDERSON DEBORAH JOAN
Mailing Name 2
Address 1 1910 RENKO RD
Address 2
Address 3 ASHTABULA OH 44004
Mortgage Company 0102
Mortgage Company CORELOGIC
Tax Year 2017

Legal

Legal Desc 1 T 13 SEC 1--22
Legal Desc 2
Legal Desc 3
Notes

Homestead Credits

Homestead Exemption NO
2.5% Reduction YES

Taxes Due

Tax Roll	Delq Taxes	1ST Taxes	2ND Taxes	Total
RP_OH		\$0.00	\$0.00	\$0.00

Taxes Charged

Tax Roll	Delq Taxes	1ST Taxes	2ND Taxes	Total
RP_OH		\$0.00	\$868.83	\$868.83

Appraised Value (100%)

Year	2017
Appraised Land	\$27,000
Appraised Building	\$67,800
Appraised Total	\$94,800
CAUV	\$0

Assessed Value (35%)

Assessed Land	\$9,450
Assessed Building	\$23,730
Assessed Total	\$33,180
CAUV	\$0
Assessed Total with CAUV	\$23,730

Value History

Year	Land	Building	Total	CAUV
2015	\$25,800	\$64,500	\$90,300	\$0
2016	\$25,800	\$64,500	\$90,300	\$0
2017	\$27,000	\$67,800	\$94,800	\$0

Land Summary

Line #	Land Class	Land Type	Land Code	Square Feet	Acres	Rate	Market Land Value
1	-	A-ACREAGE	0-RIGHT OF WAY	4,356	.1000		\$.00
2	-	A-ACREAGE	H-HOMESITE	19,166	.4400		\$27,030.00
Total:				23,522	.5400		\$27,030.00

Land 1 of 2

Line #	1
Land Type	A-ACREAGE
Land Code	0-RIGHT OF WAY
Square Feet	4,356
Acres	.1000
Land Units	
Actual Frontage	
Effective Frontage	
Override Size	
Actual Depth	
Table Rate	.00
Override Rate	
Depth Factor	1
Influence Factor	
Influence Codes	
Nbhd Factor	1.05
Notes	
Value	\$.00
Exemption Pct	
Homesite Value	

Residential

Card	1
Stories	1
Construction	1-WOOD/VINYL
Style	03-RANCH
Condo Type	-
Square Feet	1,552
Year Built	1962

Effective Year
 Year Remodeled
 PCT Complete 100

 Physical Condition A-AVERAGE CONDITION
 Grade C
 CDU AV-AVERAGE

 Total Rooms 7
 Bedrooms 3
 Family Rooms 1
 Attic 0-NONE
 Basement M-3/4 BSMT 1/4 CRAWL
 Rec Room
 Finished Basement 0
 Full Baths 1
 Half Baths 1
 Heat 4-HEAT PUMP
 Heat System 4-4
 Heating Fuel Type -
 Prefab Fireplace
 WBFP Stacks 1
 Fireplace Openings 1
 Unfinished Area 0
 Cost & Design Factor

 Dwelling Value 67,770
 Note 1
 Note 2

Addition Details

Card #	Addition #	Lower	First	Second	Third	Year Built	Area	Grade	CDU	Total Value of Addition
1	0						1,288			\$0
1	1	CSP	1SF				264			\$6,400
1	2		FGR				440			\$4,300
1	3		OFF				216			\$2,000

Sales Summary

Date	Price	Trans#	Validity	Sale Type	Instrument	Book	Page
08-JUL-2016		2346	M-SALE INVOLVING MULTIPLE PARCELS	2-LAND AND BUILDING	AF-AFFIDAVIT OF SURVIVORSHIP	615	1328
06-JAN-2010	\$0	3638	U-NOT VALIDATED	-	WD-WARRANTY DEED		
22-SEP-2009	\$124,000	2579	U-NOT VALIDATED	2-LAND AND BUILDING	WD-WARRANTY DEED		

Sales History

1 of 3

Sale Date 08-JUL-2016
 Sale Price
 Sale Type 2-LAND AND BUILDING
 Deed Transfer # 2346
 Book / Page 615 / 1328
 Source 0-AGENT / TITLE EXAMINER

 Seller BARNES JOYCE L

 Buyer ANDERSON DEBORAH JOAN

 Instrument Type AF-AFFIDAVIT OF SURVIVORSHIP
 Validity M-SALE INVOLVING MULTIPLE PARCELS
 State Code -

# of Parcels	2
Total Appraised	\$90,300
Note1	
Note2	
Sale Key	131258

Full Year Charges as of Duplicate for Tax Year 2017

Original Charge	\$2,686.28
Reduction	-\$733.36
Adjusted Charge	\$1,952.92
10% Rollback	-\$172.22
Homestead Exemption	\$.00
2.5% Homestead Rollback	-\$43.04
Total Full Year Real Estate Only	\$1,737.66
Special Assessment	\$.00
CAUV	\$.00
Total Full Year Current Charges	\$1,737.66

1st Half Current Charges (includes adjustments)

Original Charge	\$1,343.14
Reduction	-\$366.68
Adjusted Charge	\$976.46
10% Rollback	-\$86.11
Homestead Exemption	\$.00
2.5% Homestead Rollback	-\$21.52
Penalty	\$.00
Total 1st Half Real Estate Only	\$868.83
Special Assessment	\$.00
CAUV	\$.00
Total 1st Half Current Charges	\$868.83

2nd Half Current Charges (includes adjustments)

Original Charge	\$1,343.14
Reduction	-\$366.68
Adjusted Charge	\$976.46
10% Rollback	-\$86.11
Homestead Exemption	\$.00
2.5% Homestead Rollback	-\$21.52
Penalty	\$.00
Total 2nd Half Real Estate Only	\$868.83
Special Assessment	\$.00
CAUV	\$.00
Total 2nd Half Current Charges	\$868.83

Delinquent Charges

Real Estate Delq.	\$.00
Interest	\$.00
Total Delinquent Real Estate	\$.00
Special Assessment Delq.	\$.00
Interest	\$.00
Total Delinquent Special Assessment	\$.00
Total Current Delinquent	\$.00

Tax Details

Type	Action	Project #	Date	Delinquent	1st Half	2nd Half
ORG	DUP		28-DEC-17	0.00	1,343.14	1,343.14
RED	DUP		28-DEC-17	0.00	-366.68	-366.68
RLB	DUP		28-DEC-17	0.00	-86.11	-86.11
HRB	DUP		28-DEC-17	0.00	-21.52	-21.52

SAC	DUP	19005	28-DEC-17	0.00	2.25	2.25
SAC	DUP	19006	28-DEC-17	0.00	2.50	2.50
SAC	PAY	19005	30-JAN-18	0.00	-2.25	0.00
CHG	PAY		30-JAN-18	0.00	-868.83	0.00
SAC	PAY	19006	30-JAN-18	0.00	-2.50	0.00
SAC	PAY	19005	22-JUN-18	0.00	0.00	-2.25
SAC	PAY	19006	22-JUN-18	0.00	0.00	-2.50
CHG	PAY		22-JUN-18	0.00	0.00	-868.83
Total:				0.00	0.00	0.00

Tax History

Year	Project Number	Delinquent Amount	1st Half Amount	2nd Half Amount
2017	19005	\$0.00	\$2.25	\$2.25
2017	19006	\$0.00	\$2.50	\$2.50
2017	REAL	\$0.00	\$868.83	\$868.83
2016	19005	\$0.00	\$2.25	\$2.25
2016	REAL	\$0.00	\$626.52	\$626.52
2015	19005	\$0.00	\$2.25	\$2.25
2015	REAL	\$0.00	\$626.14	\$626.14
2014	19005	\$0.00	\$2.25	\$2.25
2014	REAL	\$0.00	\$599.83	\$599.83
2013	19005	\$0.00	\$2.25	\$2.25
2013	REAL	\$0.00	\$665.07	\$665.07
2012	19005	\$0.00	\$2.25	\$2.25
2012	REAL	\$0.00	\$647.97	\$647.97
2011	19005	\$0.00	\$2.25	\$2.25
2011	REAL	\$0.00	\$660.67	\$660.67
2010	19005	\$0.00	\$2.25	\$2.25
2010	REAL	\$0.00	\$935.44	\$935.44
2009	19005	\$0.00	\$2.25	\$2.25
2009	REAL	\$0.00	\$700.79	\$700.79

Payment History

Roll	Tax Year	Effective Date	Business Date	Amount
RP_OH	2017	22-JUN-18	22-JUN-18	\$873.58
RP_OH	2017	30-JAN-18	30-JAN-18	\$873.58
RP_OH	2016	29-JUN-17	29-JUN-17	\$628.77
RP_OH	2016	02-FEB-17	02-FEB-17	\$628.77
RP_OH	2015	01-JUL-16	01-JUL-16	\$628.39
RP_OH	2015	01-FEB-16	01-FEB-16	\$628.39
RP_OH	2014	26-JUN-15	26-JUN-15	\$602.08
RP_OH	2014	05-FEB-15	05-FEB-15	\$602.08
RP_OH	2013	03-JUL-14	03-JUL-14	\$667.32
RP_OH	2013	05-FEB-14	05-FEB-14	\$667.32
RP_OH	2012	08-JUL-13	08-JUL-13	\$650.22
RP_OH	2012	31-JAN-13	31-JAN-13	\$650.22
RP_OH	2011	12-JUN-12	12-JUN-12	\$662.92
RP_OH	2011	15-FEB-12	15-FEB-12	\$662.92
RP_OH	2010	09-JUN-11	09-JUN-11	\$937.69
RP_OH	2010	01-FEB-11	01-FEB-11	\$937.69
RP_OH	2009	10-JUN-10	10-JUN-10	\$703.04
RP_OH	2009	26-JAN-10	26-JAN-10	\$703.04

Special Assessment Charges

Year	Project	Date	Desc	Charge	Fee	Total
2017	19006	11-DEC-17	COUNTYWIDE RECYCLING PROGRAM	\$5.00		\$5.00
2017	19005	11-DEC-17	9-1-1 EMERGENCY TELEPHONE	\$4.50		\$4.50

Total:

\$9.50 \$0.00 \$9.50

Special Assessment Payoff Details

Year	Project	Desc	Cycle	Taxes	Fee	Penalty/Interest	Paid	Total
2015	19005	9-1-1 EMERGENCY TELEPHONE	1	\$2.25	\$0.00	\$0.00	-\$2.25	\$0.00
2015	19005	9-1-1 EMERGENCY TELEPHONE	2	\$2.25	\$0.00	\$0.00	-\$2.25	\$0.00
2016	19005	9-1-1 EMERGENCY TELEPHONE	1	\$2.25	\$0.00	\$0.00	-\$2.25	\$0.00
2016	19005	9-1-1 EMERGENCY TELEPHONE	2	\$2.25	\$0.00	\$0.00	-\$2.25	\$0.00
2017	19005	9-1-1 EMERGENCY TELEPHONE	1	\$2.25	\$0.00	\$0.00	-\$2.25	\$0.00
2017	19005	9-1-1 EMERGENCY TELEPHONE	2	\$2.25	\$0.00	\$0.00	-\$2.25	\$0.00
2017	19006	COUNTYWIDE RECYCLING PROGRAM	1	\$2.50	\$0.00	\$0.00	-\$2.50	\$0.00
2017	19006	COUNTYWIDE RECYCLING PROGRAM	2	\$2.50	\$0.00	\$0.00	-\$2.50	\$0.00
Total:				\$18.50	\$0.00	\$0.00	-\$18.50	\$0.00

Special Assessment Payoff Totals

Project	Desc	Taxes	Fee	Penalty/Interest	Paid	Total
19005	9-1-1 EMERGENCY TELEPHONE	\$13.50	\$0.00	\$0.00	-\$13.50	\$0.00
19006	COUNTYWIDE RECYCLING PROGRAM	\$5.00	\$0.00	\$0.00	-\$5.00	\$0.00
Total:		\$18.50	\$0.00	\$0.00	-\$18.50	\$0.00

Special Assessment Project Details

Project	Project Name	Year Beg	Year End	Calc Code	Project Type	Bond Date	Int Months	Int Rate	Ord Code	Unit Type	Notes
19005	9-1-1 EMERGENCY TELEPHONE	1991	2999	3	90	01-JAN-1991			101		
19006	COUNTYWIDE RECYCLING PROGRAM	2017	2999	3	90						

Yearly Project Details

Tax Year	Project	Project Name	Base Factor	Interest Rate	Notes
2015	19005	9-1-1 EMERGENCY TELEPHONE			
2016	19005	9-1-1 EMERGENCY TELEPHONE			
2017	19005	9-1-1 EMERGENCY TELEPHONE			
2017	19006	COUNTYWIDE RECYCLING PROGRAM			

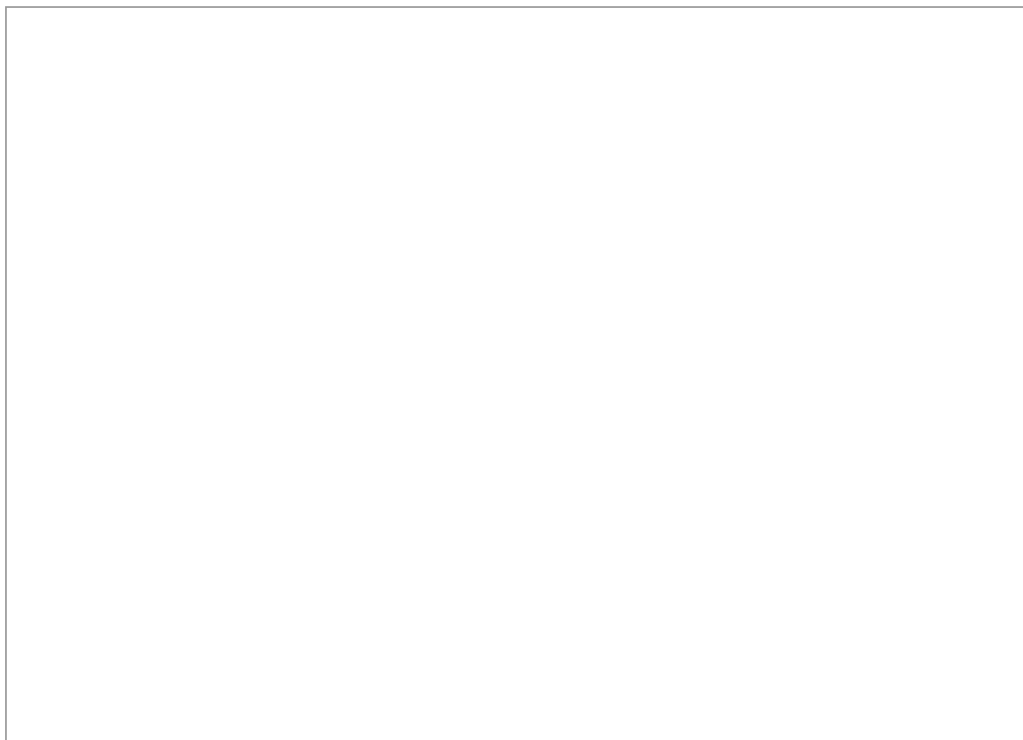

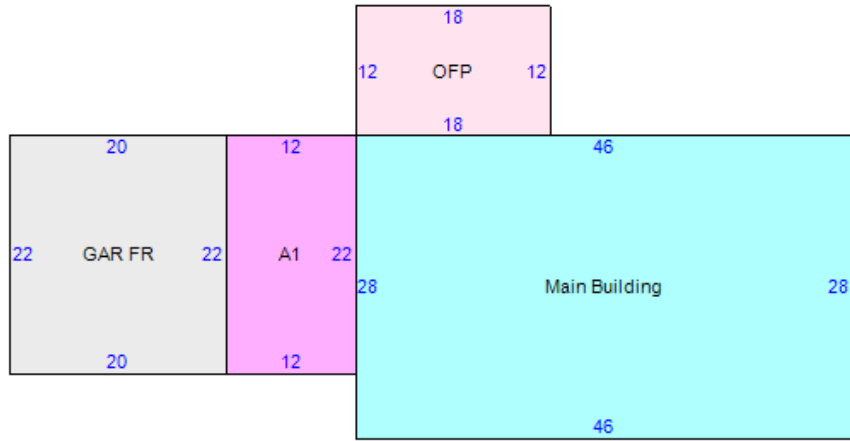

Item	Area
Main Building	1288
FND CRAWL/1S FR - CSP/1SF:FNDN - CRAWL ONLY/1S FR FRAME	264
GAR FR - FGR:GAR - FRAME	440
OFP:PORCH - OPEN FRAME	216



480040002500 10/24/2012