

Portage County, Ohio - Property Record Card  
Parcel: 41-058-10-00-094-000  
Card: 1

GENERAL PARCEL INFORMATION

Owner	BUTLER ANTHONY
Property Address	9848 BLANTON
Mailing Address	9848 BLANTON DR WINDHAM OH 44288
Land Use	510 - SINGLE FAMILY DWLG
Legal Description	WINDHAM ESTS 2 LOT 131

VALUATION

	Appraised	Assessed
Land Value	\$11,700.00	\$4,100.00
Improvements Value	\$38,100.00	\$13,340.00
CAUV Value	\$0.00	\$0.00
Taxable Value	\$17,440.00	

LAND

Land Type	Acreage	Depth	Frontage	D. Factor	Value
L1 - Regular Lot	0.2066	150	60	111	11660

AGRICULTURAL

Land Type	Land Usage	Soil Type	Acres	Value
-----------	------------	-----------	-------	-------

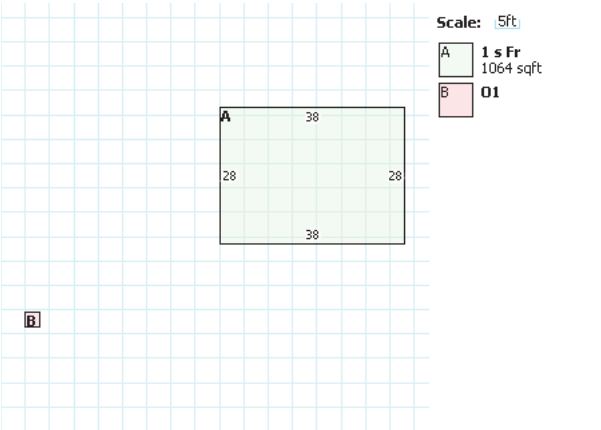

RESIDENTIAL

Building Style	CONVENTIONAL	Full Baths	1
Year Built	1975	Half Baths	0
Stories	1	Basement	NONE
Finished Area	1064	Finished Basement Area	0
First Floor Area	1064	Heating	BASE
Half Floor Area	0	Cooling	CENTRAL
Upper Floor Area	0	Exterior Wall	FRAME/SIDING
Rooms	5	Attic	NONE
Bedrooms	3	Number of Fireplace Openings	0
Family Rooms	0	Number of Fireplace Stacks	0

ADDITIONS

IMPROVEMENTS

Description	Year Built	Dimension	Area	Value
Shed Utility - 60	0	0x0	0	\$0.00

SALES

Date	Buyer	Seller	Price
3/12/2013	BUTLER ANTHONY	BUTLER SALLY A	0
3/7/2008	BUTLER SALLY A	ENSMINGER MATTHEW T	87000
11/19/1996	ENSMINGER MATTHEW T	Unknown	60500

COMMERCIAL

--