

Soils Map

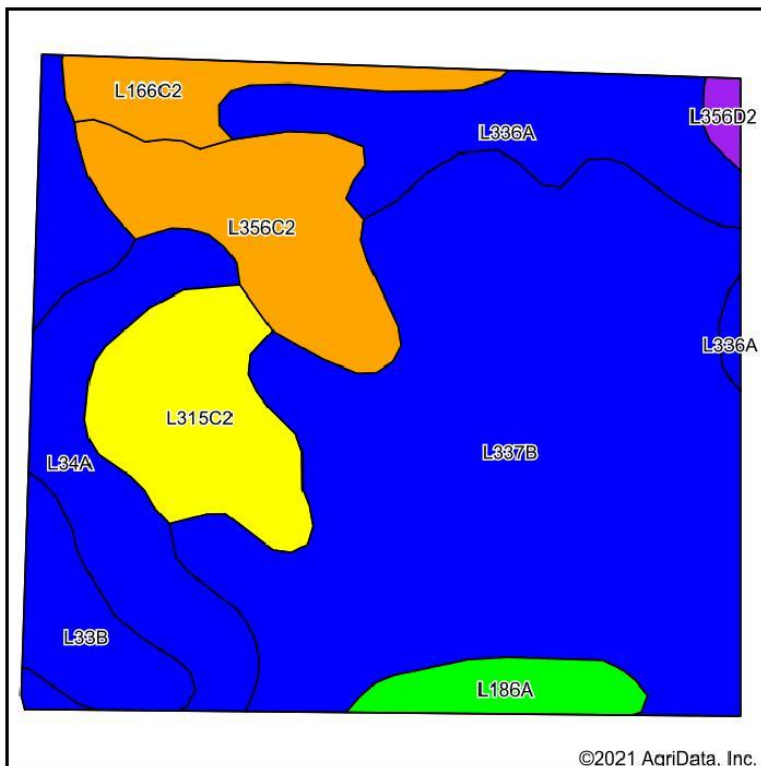

©2021 AgriData, Inc.

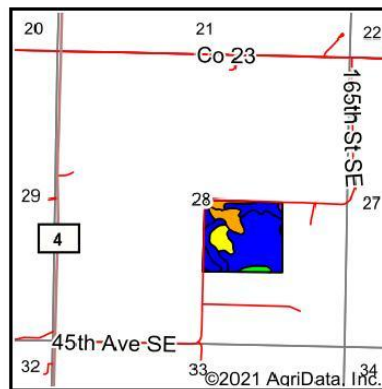

State: **Minnesota**
 County: **Kandiyohi**
 Location: **28-119N-33W**
 Township: **Gennessee**
 Acres: **42.39**
 Date: **9/14/2021**



Soils data provided by USDA and NRCS.

Area Symbol: MN067, Soil Area Version: 19

Code	Soil Description	Acres	Percent of field	PI Legend	Non-Irr Class *c	Productivity Index	Bromegrass alfalfa	Bromegrass alfalfa hay	Corn	Reed canarygrass	Soybeans	Spring wheat	*n NCCPI Soybeans
L337B	Wadenill-Sunburg complex, 2 to 6 percent slopes	20.41	48.1%		Ille	88	5.3	4.1	161		48	48	66
L336A	Arctander, overwash-Arctander complex, 1 to 4 percent slopes	4.15	9.8%		Ilw	88	5.1	3.9	161		48	48	84
L34A	Cosmos silty clay, 0 to 2 percent slopes	4.09	9.6%		Ilw	81	4.9	3.2	148	5.5	45	49	60
L356C2	Sunburg-Wadenill complex, 6 to 12 percent slopes, moderately eroded	3.91	9.2%		Ille	77	4.8	3.7	141		42	44	56
L315C2	Sunburg-Wadenill-Hawick complex, 6 to 12 percent slopes, moderately eroded	3.59	8.5%		Ille	67	4.3	3.3	123		37	41	52
L33B	Kandiyohi clay, 2 to 5 percent slopes	3.01	7.1%		Ille	90	5	3.8	165		50	49	60

L166C2	Newlondon-Strout complex, 6 to 12 percent slopes, moderately eroded	1.70	4.0%		Ille	77	4.5	3.4	141		42	44	49
L186A	Danielson-Danielson, overwash complex, 1 to 4 percent slopes	1.28	3.0%		Ilw	93	5	3.8	170		51	49	61
L356D2	Sunburg-Wadenill complex, 12 to 18 percent slopes, moderately eroded	0.25	0.6%		Ive	59	4	3.1	108		32	37	51
Weighted Average						84.2	5	3.8	154.1	0.5	46.1	47	*n 63.7

*n: The aggregation method is "Weighted Average using all components"
 *c: Using Capabilities Class Dominant Condition Aggregation Method
 Soils data provided by USDA and NRCS.