

# 32136 PARKVIEW DR

27-00743.000

?

General Info Tax History Distribution Levy Tax Estimator

## Property Information

Parcel ID	27-00743.000	Property Address:	32136 PARKVIEW DR
Owner Name	BREWER RICHARD F II	Tax Payer Address:	CORELOGIC
Owner Address	32136 PARKVIEW HANOVERTON OH 44423		1 FIRST AMERICAN WAY WESTLAKE TX 76262 USA
Tax District	27 HANOVER TWP-UNITED LSD		
School District	1510 UNITED LSD		
Neighborhood	13502 GUILFORD		
Use Code	510 One Family Dwelling		
Acres	.10800		
Description	4 15 2 CEN PT SEC .108A		

Current Value				Recent Transfer	
Board of Revision	N	Mkt Land Value	\$11,700	Account Number	27-00X2G.019000
Homestead/Disability	N	CAUV	\$0	# Parcels	1
2.5% Reduction	Y	Mkt Impr Value	\$57,000	Deed Type	EX-EXEMPT
Divided Property	N	Total	\$68,700	Amount	\$0
New Construction	N	<b>Current Tax</b>		Sale Date	2/26/2016
Foreclosure	N	Annual Tax *	\$1,075.86	Conveyance	
Other Assessments	Y	Paid **	\$1,075.86	Deed #	266
Front Ft.	0	Delq	\$0.00		

<< Previous Card Card 1 of 1 Next Card >>

### Dwelling Information

Sq Ft Finished	1440	Room Count	5	Fireplace(s)	1
1st Floor Area	1440	Story Height	1	Year Built	1955
Upper Floor Area	0	# Bedrooms	3	Year Remodeled	1998
Half Story Area	0	Full Baths	1	Grade	90
Attic Area	0	Half Baths	0	Style	Ranch
Finished Basement	0	Heating	Forced Air	Ext Walls	Fr
Basement Type	None	Air Cond	None		

### Land

Land Type	Acres	Square Ft.	Actual Frontage	Eff. Frontage	Depth	No Of Units	Value
F4Front Lot	.11010	0		47.00000	102.00000	0	\$11,700

### CAUV Land

No CAUV Land On This Property

### Legal Disclaimer

Card 1

### Improvements

IMPR Type	Description	Area	Length	Width	Year Built
Addition	Wood Deck	152 SQ FT			
Feature	Fireplace Openings	1			
Feature	Fireplace Stacks	1			

Card - 1

-- Card 1

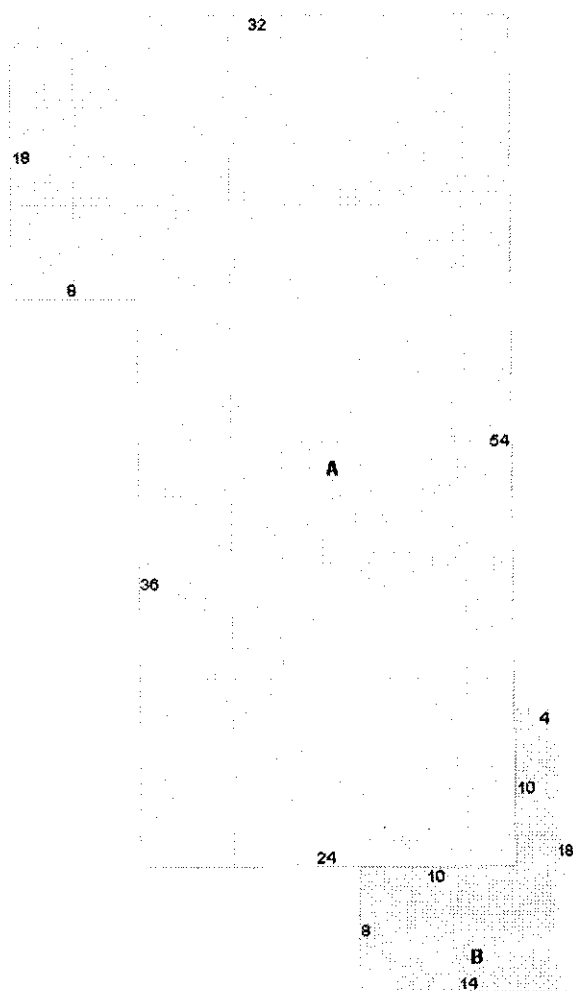

0.079s

Scale: 5 ft

ID	Label	Area	Perimeter	Dimension
A	1 s Fi	1440	172	N/A
B	WDDK	152	64	N/A