

Lake County, Ohio - Property Record Card

Parcel: 01B102B000790 Card: 1

Owner BROOS MICHAEL R
Address 1269 DORCHESTER
Land Use (510) R - SINGLE FAMILY DWELLING, PLATTED LOT
Class RESIDENTIAL
Legal Description L[120 A[MAD BCH 50

SKETCH

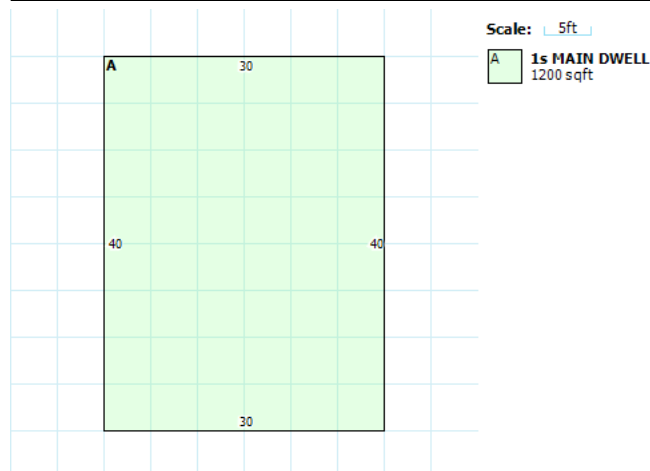

RESIDENTIAL

Building Style	RANCH	FullBaths	1
Sq.Ft.	1200	Half Baths	1
Year Built	1996	Basement	NONE
Stories	1	Basement Area	0
Exterial Wall	ALUMINIUM/VINYL SIDING	Rec Room Area	0
Rooms	5	Heat Fuel Type	GAS
Bedrooms	3	Heat/Cool	NORMAL
Family Rooms	0	Attic	NONE
Fireplace Openings(Stacks)	()	Trim	0

LAND

Code	Frontage	Depth	Acreage	SqFt
1	50	127	N/A	N/A

VALUATION

	Appraised	Assessed
Land Value	\$17,510.00	\$6,130.00
Building Value	\$74,030.00	\$25,910.00
Total Value	\$91,540.00	\$32,040.00
CAUV Value	\$0.00	
Taxable Value	\$32,040.00	

PERMITS

IMPROVEMENTS

Card	Description	Year Built	Dimensions	Value
1	RG1 - FRAME	1996	12x20	\$1,860.00

SALES

Date	Buyer	Seller	Price	Validity
2/9/2007	BROOS MICHAEL R	REED MARY M	\$122,000.00	
5/6/1999	PETERS SCOTT E	PETERS SCOTT E	\$83,000.00	0
2/1/1999	PETERS SCOTT E	PETERS SCOTT E	\$78,000.00	8
7/10/1996	PETERS SCOTT E	LEONI ANTHONY	\$78,000.00	0
9/18/1995			\$11,500.00	8
10/21/1988			\$0.00	8

Note: Appraised valuations and taxes are reflective of the current tax year only. All land and building data changes made since the last tax duplicate will be reflected in the subsequent tax year's appraised valuations and corresponding tax bills.

Disclaimer: Information included in this site is believed to be accurate, but is not guaranteed. Lake County is not liable for errors or omissions.