

# Lake County, Ohio - Property Record Card

## Parcel: 01B102B000330 Card: 1

**Owner** GILBERT CYNTHIA M  
**Address** 1246 ARGYLE  
**Land Use** (510) R - SINGLE FAMILY DWELLING, PLATTED LOT  
**Class** RESIDENTIAL  
**Legal Description** L[75 A[MAD BEACH 50

### SKETCH

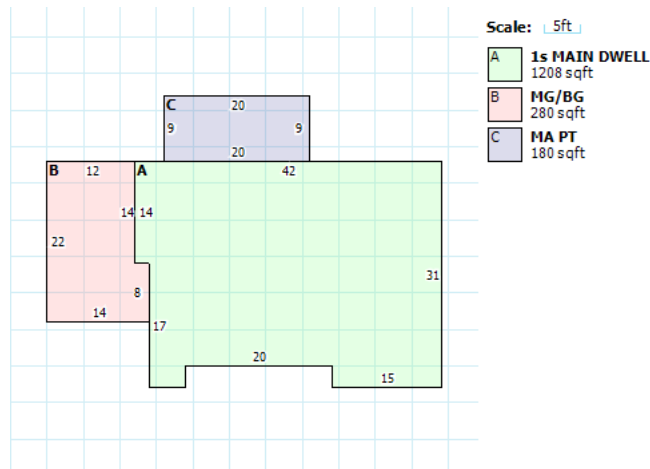

### RESIDENTIAL

Building Style	RANCH	FullBaths	1
Sq.Ft.	1208	Half Baths	0
Year Built	1950	Basement	NONE
Stories	1	Basement Area	0
Exterial Wall	BRICK	Rec Room Area	0
Rooms	6	Heat Fuel Type	GAS
Bedrooms	3	Heat/Cool	NORMAL
Family Rooms	0	Attic	NONE
Fireplace Openings(Stacks)	()	Trim	0

### LAND

Code	Frontage	Depth	Acreage	SqFt
1	50	125	N/A	N/A

### VALUATION

	Appraised	Assessed
Land Value	\$17,340.00	\$6,070.00
Building Value	\$60,720.00	\$21,250.00
Total Value	\$78,060.00	\$27,320.00
CAUV Value		\$0.00
Taxable Value		\$27,320.00

### PERMITS

### IMPROVEMENTS

### SALES

Date	Buyer	Seller	Price	Validity
5/17/2013	GILBERT CYNTHIA M	PRECISION TOOLING	\$90,400.00	1
9/2/2004	PRECISION TOOLING	SEC OF HOUSING AND URBAN	\$0.00	
5/18/2004	SEC OF HOUSING AND URBAN	PEINE ALLEN R JR	\$0.00	
4/27/2001	PEINE ALLEN R JR	CARLSON RANDALL E	\$82,400.00	1

Note: Appraised valuations and taxes are reflective of the current tax year only. All land and building data changes made since the last tax duplicate will be reflected in the subsequent tax year's appraised valuations and corresponding tax bills.

Disclaimer: Information included in this site is believed to be accurate, but is not guaranteed. Lake County is not liable for errors or omissions.