

185 HIGHLAND AVE

51-00885.000

?

General Info Tax History Distribution Levy Tax Estimator

**Property Information**

Parcel ID	51-00885.000	Property Address:
Owner Name	HILTBRAND JULIE R	185 HIGHLAND AVE
Owner Address	185 HIGHLAND SALEM OH 44460	
Tax District	51 SALEM CITY	Tax Payer Address:
School District	1508 SALEM CSD	CORELOGIC
Neighborhood	11715 SALEM CITY	1 FIRST AMERICAN WAY
Use Code	510 One Family Dwelling	WESTLAKE TX 76262
Acres	.00000	USA
Description		
N PT S 12 & 11 T & E 50 TOD DES TO BRYCE HILTBRAND, RILYNN HILTBRAND & BRINSLEY WITHERSPOON 9/6/17		

		Current Value		Recent Transfer	
Board of Revision	N	Mkt Land Value	\$14,800	Account Number	51-00019.018000
Homestead/Disability	N	CAUV	\$0	# Parcels	2
2.5% Reduction	Y	Mkt Impr Value	\$58,400	Deed Type	WD-WARRANTY DEED
Divided Property	N	Total	\$73,200	Amount	\$115,000
New Construction	N	<b>Current Tax</b>		Sale Date	7/28/2017
Foreclosure	N	Annual Tax *	\$1,049.74	Conveyance	1135
Other Assessments	N	Paid **	\$524.87	Deed #	
Front Ft.	0	Delq	\$0.00		

<< Previous Card Card 1 of 1 Next Card >>

Dwelling Information					
Sq Ft Finished	1736	Room Count	8	Fireplace(s)	0
1st Floor Area	868	Story Height	2	Year Built	1900
Upper Floor Area	868	# Bedrooms	5	Year Remodeled	1997
Half Story Area	0	Full Baths	1	Grade	110
Attic Area	0	Half Baths	1	Style	Single Fam
Finished Basement	0	Heating	Forced Air	Ext Walls	Fr
Basement Type	Full Basement	Air Cond	None		

Land							
Land Type	Acres	Square Ft.	Actual Frontage	Eff. Frontage	Depth	No Of Units	Value
F4Front Lot	.11480	0	100.00000	100.00000	50.00000	0	\$14,760

**CAUV Land**  
No CAUV Land On This Property

**Legal Disclaimer**

Card - 1

Improvements					
IMPR Type	Description	Area	Length	Width	Year Built
Addition	Attch Fr Garage	304 SQ FT			
Addition	Open Fr Porch	210 SQ FT			
Addition	Wood Deck	264 SQ FT			
Feature	Finished Attic	868			

Card - 1

-- Card 1

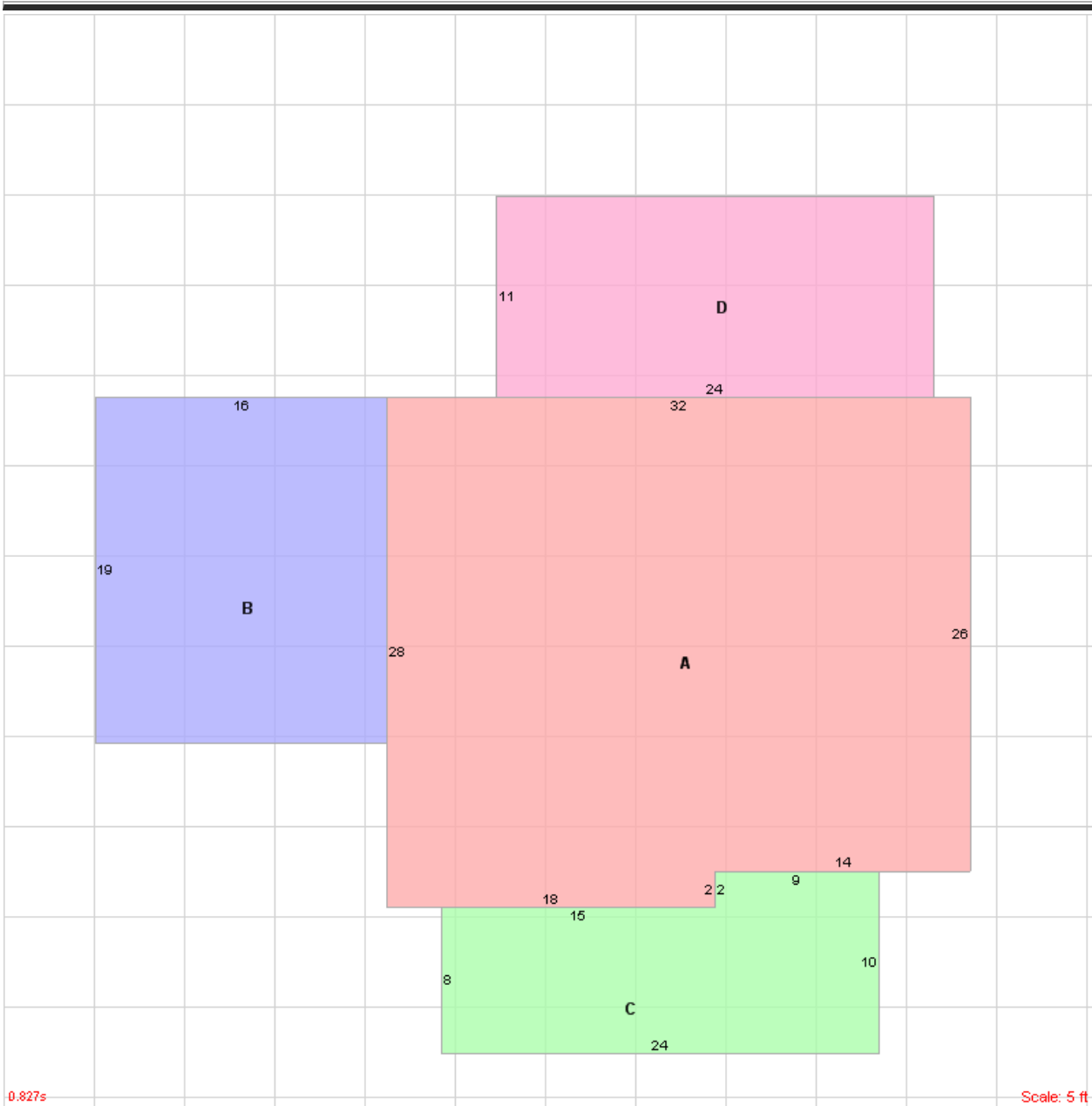

0.827s

Scale: 5 ft

ID	Label	Area	Perimeter	Dimension
A	$\frac{Fr.A}{2sFr}$ B	868	120	N/A
B	FG	304	70	N/A
C	OFF	210	68	N/A
D	WDDK	264	70	N/A