

Portage County, Ohio - Property Record Card  
 Parcel: 03-001-32-00-098-000  
 Card: 1

**GENERAL PARCEL INFORMATION**

Owner KYLE GINA MARIE ELIZABETH  
 Property Address 955 EAST BV  
 Mailing Address 955 EAST BLVD  
 AURORA OH 44202  
 Land Use 510 - SINGLE FAMILY DWLG  
 Legal Description WRL CO LOT 618 F 50.00

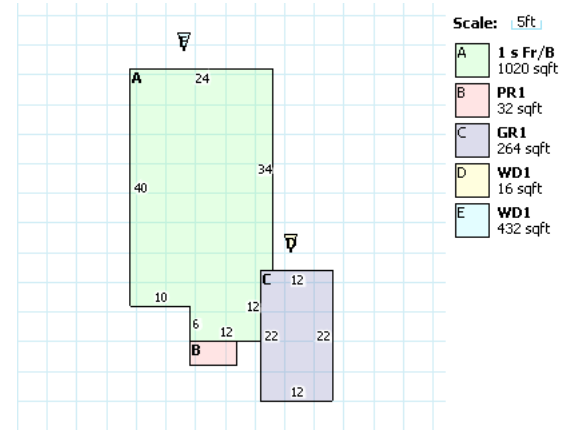

**VALUATION**

	Appraised	Assessed
Land Value	\$29,500.00	\$10,330.00
Improvements Value	\$101,600.00	\$35,560.00
CAUV Value	\$0.00	\$0.00
Taxable Value	\$45,890.00	

**RESIDENTIAL**

Building Style	CONVENTIONAL	Full Baths	2
Year Built	1995	Half Baths	0
Stories	1	Basement	FULL BASEMENT
Finished Area	1020	Finished Basement Area	0
First Floor Area	1020	Heating	BASE
Half Floor Area	0	Cooling	CENTRAL
Upper Floor Area	0	Exterior Wall	FRAME/SIDING
Rooms	5	Attic	NONE
Bedrooms	2	Number of Fireplace Openings	0
Family Rooms	0	Number of Fireplace Stacks	0

**LAND**

Land Type	Acreage	Depth	Frontage	D. Factor	Value
L1 - Regular Lot	0.272	237	50	124	29450

**ADDITIONS**

Description	Area	Year Built	Value
WD1 - Wood Deck	432	0	\$4,600.00
WD1 - Wood Deck	16	0	\$360.00
GR1 - Garage Frame	264	0	\$5,440.00
PR1 - Porch Frame - Open	32	0	\$1,720.00

**IMPROVEMENTS**

**AGRICULTURAL**

Land Type	Land Usage	Soil Type	Acres	Value
-----------	------------	-----------	-------	-------

**SALES**

Date	Buyer	Seller	Price
1/30/1995	KYLE GINA MARIE	Unknown	14000

**COMMERCIAL**