

# Lake County, Ohio - Property Record Card

## Parcel: 01B112A120880 Card: 1

**Owner** CRELLIN MICHAEL P & AMANDA L  
**Address** 6242 SELKIRK  
**Land Use** (510) R - SINGLE FAMILY DWELLING, PLATTED LOT  
**Class** RESIDENTIAL  
**Legal Description** L[1215 A[M G L 50.43

### SKETCH

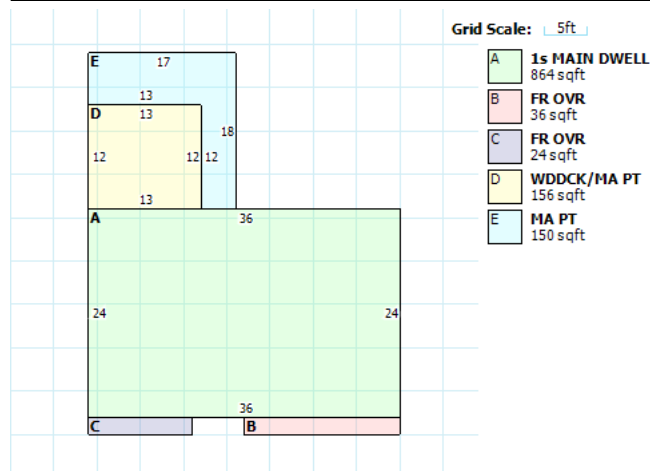

### RESIDENTIAL

|                            |                        |                |                 |
|----------------------------|------------------------|----------------|-----------------|
| Building Style             | BI-LEVEL               | FullBaths      | 1               |
| Sq.Ft.                     | 924                    | Half Baths     | 0               |
| Year Built                 | 1971                   | Basement       | FULL            |
| Stories                    | 1                      | Basement Area  | 860             |
| Exterial Wall              | ALUMINIUM/VINYL SIDING | Rec Room Area  | 0               |
| Rooms                      | 7                      | Heat Fuel Type | GAS             |
| Bedrooms                   | 4                      | Heat/Cool      | + AIR CONDITION |
| Family Rooms               | 0                      | Attic          | NONE            |
| Fireplace Openings(Stacks) | ()                     | Trim           | 0               |

### LAND

| Code | Frontage | Depth | Acreage | SqFt |
|------|----------|-------|---------|------|
| 1    | 50       | 110   | N/A     | N/A  |

### VALUATION

|                | Appraised    | Assessed    |
|----------------|--------------|-------------|
| Land Value     | \$18,720.00  | \$6,550.00  |
| Building Value | \$94,090.00  | \$32,930.00 |
| Total Value    | \$112,810.00 | \$39,480.00 |
| CAUV Value     | \$0.00       |             |
| Taxable Value  | \$39,480.00  |             |

### PERMITS

### IMPROVEMENTS

### SALES

| Date      | Buyer             | Seller        | Price         | Validity |
|-----------|-------------------|---------------|---------------|----------|
| 8/26/2005 | CRELLIN MICHAEL P | PAYNE CAROL S | \$137,000.000 |          |
| 11/13/198 |                   |               | \$44,400.00   | 0        |
| 4/11/1989 |                   |               | \$0.00        | 8        |
| 1/28/1982 |                   |               | \$51,900.00   | 8        |

Note: Appraised valuations and taxes are reflective of the current tax year only. All land and building data changes made since the last tax duplicate will be reflected in the subsequent tax year's appraised valuations and corresponding tax bills.

Disclaimer: Information included in this site is believed to be accurate, but is not guaranteed. Lake County is not liable for errors or omissions.